

INSTALLATION MANUAL
HIGH SECURITY
METAL CBU TYPES I, II, III, AND IV

1565 “Rev4” SERIES



5935 CORPORATE DRIVE
MANHATTAN, KANSAS 66503

Ph. 800-275-1747
Fax. 800-275-5081

www.auth-florence.com

TABLE OF CONTENTS

| DESCRIPTION | PAGE |
|--|------|
| CBU INFORMATION | 2 |
| SITE PREPARATION AND PEDESTAL INSTALLATION | 3 |
| SECURITY TOOL REQUIREMENTS | 4 |
| INSTALLATION OF AN ARROW LOCK | 5 |
| PARCEL ARROW LOCK INSTALLATION | 7 |
| PEDESTAL TO CBU INSTALLATION | 9 |

YOUR ISO 9001 MAILBOX SUPPLIER

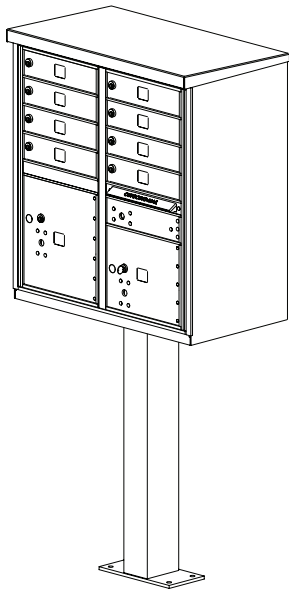

I

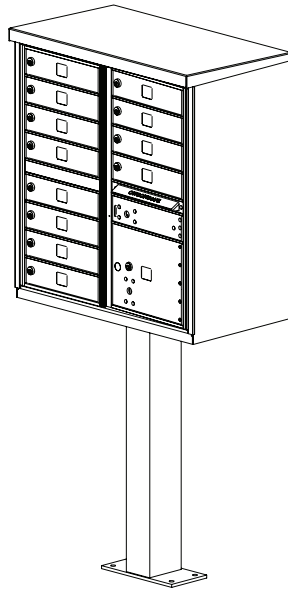

II

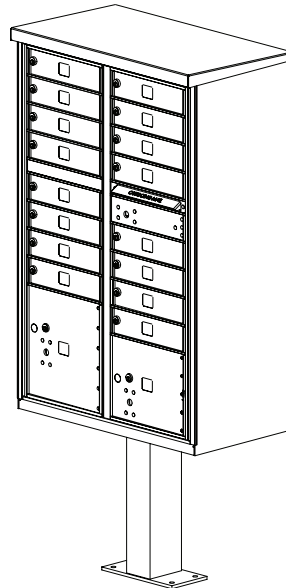

III

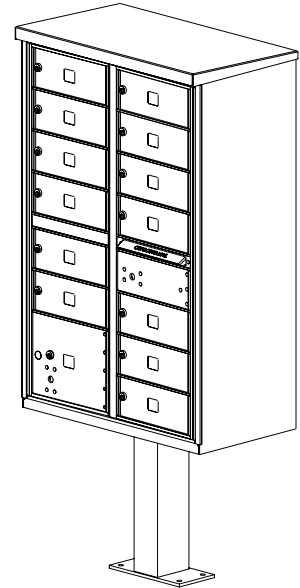

IV

| | TYPE I | TYPE II | TYPE III | TYPE IV |
|-------------------------------------|-----------------|-----------------|-----------------|-----------------|
| INSTALLED HEIGHT | 62" | 62" | 62" | 62" |
| | | | | |
| DEPTH | 17-7/8" | 17-7/8" | 17-7/8" | 17-7/8" |
| | | | | |
| WIDTH | 30-1/2" | 30-1/2" | 30-1/2" | 30-1/2" |
| | | | | |
| WEIGHT (WITHOUT PEDESTAL) | 114 LBS* | 113 LBS* | 151 LBS | 142 LBS* |
| | | | | |
| WEIGHT (WITH PEDESTAL) | 137 LBS* | 136 LBS* | 166 LBS | 157 LBS* |
| | | | | |
| QTY OF STANDARD COMPARTMENTS | 8 | 12 | 16 | 13 |
| | | | | |
| QTY OF PARCEL COMPARTMENTS | 2 | 1 | 2 | 1 |
| | | | | |
| PARCEL COMPARTMENT HEIGHT | 10", 13" | 10" | 10", 13" | 10" |
| | | | | |

*** - DENOTES PROJECTED WEIGHTS - ACTUAL WEIGHTS TO BE DETERMINED**

SINGLE UNIT

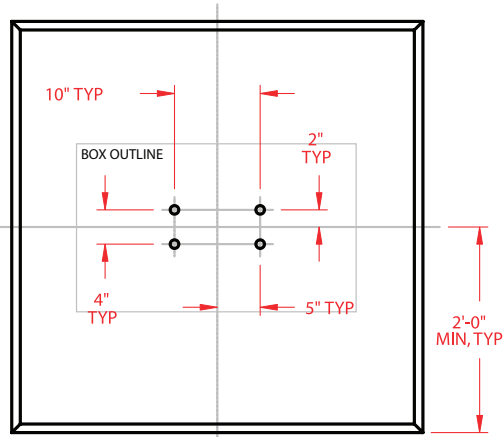

CHAMFER ALL EDGES IN LANDSCAPE AREAS. TOOL FLUSH WITH ADJOINING SURFACES IN PAVED AREAS.

MULTI-UNIT

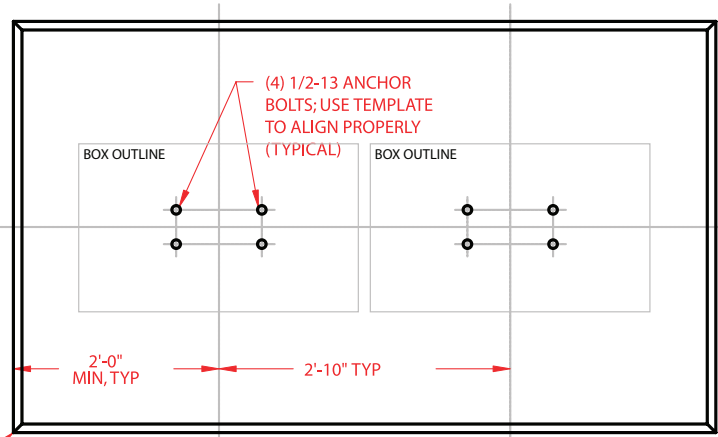

ARRANGE MULTIPLE ANCHOR BOLT SETS AS REQUIRED; BASE NOT TO EXCEED 16'-0"

NOTE:
CONCRETE SHALL HAVE A COMPRESSIVE STRENGTH OF 3000 PSI @ 28 DAYS, CONTAIN 4% MIN ~ 6% MAX AIR ENTRAPMENT AND BE PLACED WITH A 3.50 ~ 4.50 SLUMP IN ACCORDANCE TO 301.

MATCH EXISTING GRADE IN PAVED AREAS

CBU PEDESTAL

REINFORCING STEEL RODS ON 14.00" CENTERS MAXIMUM EACH WAY (CONFORMING TO ASTM A615 GRADE 60)

8.00 MIN

8.00 MIN

OPTIONAL COMPACT GRAVEL OR CRUSHED STONE (OMIT WHERE SOLID ROCK OCCURS)

FIRM UNDISTURBED SOIL OR WELL-COMPACTED FILL

MAXIMUM FROST DEPTH

SLOPE SURFACE 0.25 INCH PER FOOT ON ALL SIDES FOR DRAINAGE

MOUNTING NUT/WASHER (NOT INCLUDED)

BUTYL RUBBER PAD

4X .50 DIA ANCHOR BOLTS (CONFORMING TO ASTM A193, GRADE B8M TYPE 316 STAINLESS STEEL, NOT INCLUDED)

BROOM FINISH

3.00

SITE PREPARATION AND PEDESTAL INSTALLATION

HIGH SECURITY METAL CBU TYPES I, II, III, AND IV

1565 "REV 4" SERIES

IMPORTANT NOTICE FOR USPS INSTALLERS

METAL CBU TYPES I, II, III, AND IV

1565 “REV 4” SERIES

*INSTALLER MUST ORDER McGARD SCREW DRIVER
(USPS - MAIL EQUIPMENT SHOP PART NUMBER 110050)
TO INSTALL AND SERVICE THE PARCEL ARROW LOCK COVER
ON THE NEW AUTH-FLORENCE CBU.*

*IF THE **McGARD SCREW DRIVER MES NO. 110050** NEEDS TO BE ORDERED,
IT MAY BE ORDERED BY FAXING AN “OFF CATALOG” eBUY REQUEST TO:*

USPS MAIL EQUIPMENT SHOP
FAX NO. (202) 281-2643



*MODEL SERIES 1565 (HIGH SECURITY CBU) ALSO REQUIRES THE
McGARD HEX KEY DRIVER MES NO. 110005
TO INSTALL AND SERVICE THE PEDESTAL TO CONCRETE MOUNTING NUTS.*

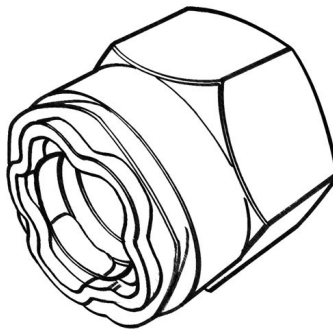

*QUESTIONS? CALL THE USPS MAIL EQUIPMENT SHOP AT **(202) 281-2620***

INSTALLATION OF ARROW LOCK

HIGH SECURITY METAL CBU TYPES I, II, III, AND IV

1565 "REV 4" SERIES

- 1.** OPEN ARROW LOCK DOOR
- 2.** REMOVE FOUR (4) 84199 1/4-20 LOCK NUTS, AS WELL AS 92303 PLATE - LOCK SUPPORT
- 3.** PLACE ARROW LOCK INTO POSITION
- 4.** INSTALL 92303 PLATE - LOCK SUPPORT AS SHOWN
- 5.** REPLACE FOUR (4) 84199 1/4-20 LOCK NUTS

| REQUIRED TOOLS | | PART # | DESCRIPTION |
|--------------------|--|--------|----------------------|
| 3/8" SOCKET WRENCH | | 84199 | 1/4-20 LOCK NUT |
| PLIERS | | 92303 | PLATE - LOCK SUPPORT |
| | | | ARROW LOCK |
| | | | |
| | | | |

INSTALLATION OF AN ARROW LOCK

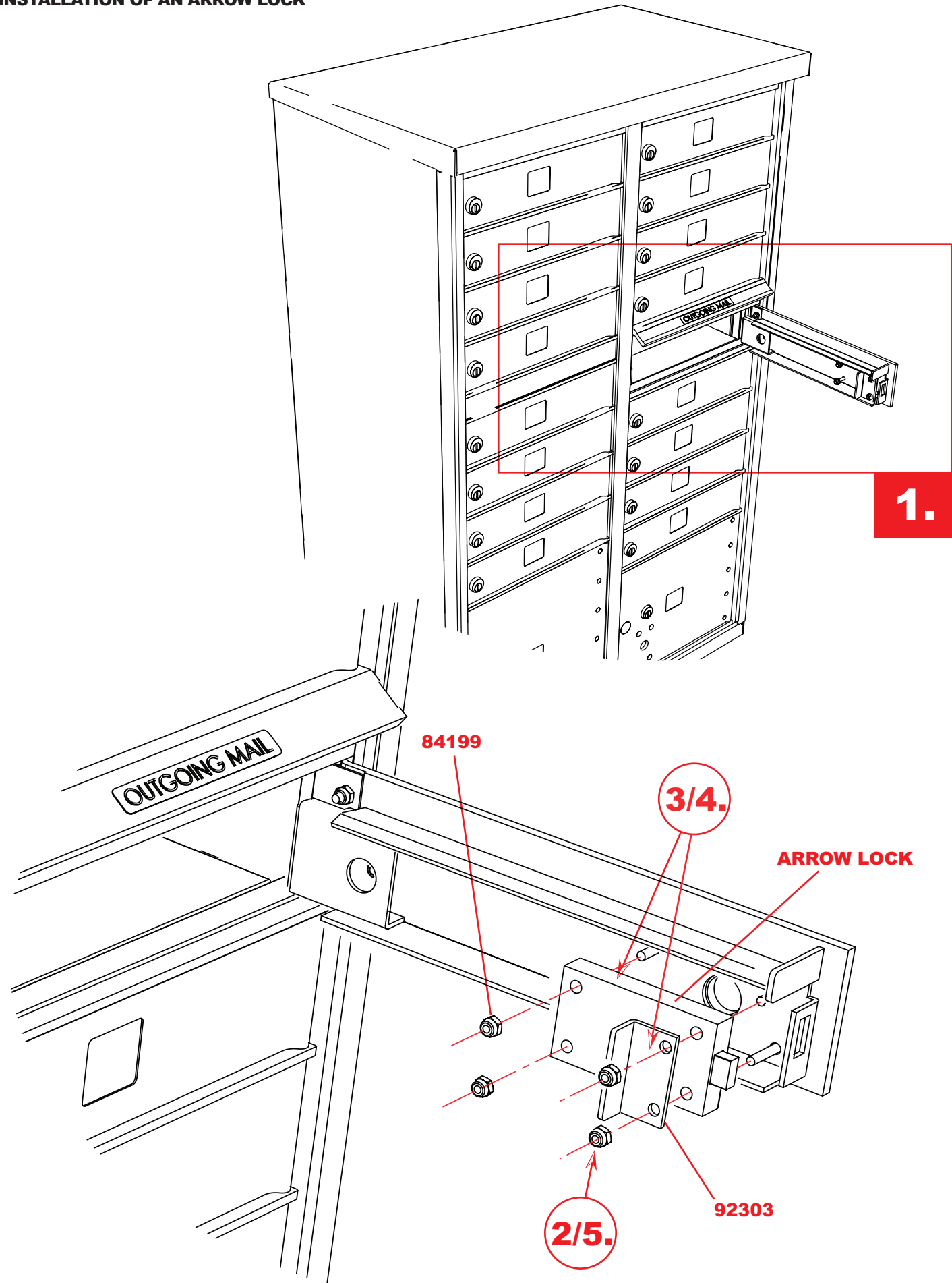

PARCEL ARROW LOCK INSTALLATION

HIGH SECURITY METAL CBU TYPES I, II, III AND IV

1565 "REV 4" SERIES

- 1.** OPEN PARCEL DOOR AND REMOVE
FOUR (4) 86091 10-32 LOCK NUTS

- 2.** INSTALL ARROW LOCK AS SHOWN AND
REPLACE FOUR (4) 86091 10-32 LOCK
NUTS

- 3.** INSTALL PARCEL LOCK COVER 91255
USING TWO (2) 84994 10-32 X .375 1-WAY
SCREWS, AND ONE (1) 84995 8-32 X .250
1-WAY SCREW

- 4.** INSTALL PARCEL LOCK COVER 91259
USING TWO (2) 84993 10-32 X .312
McGARD SCREWS

| REQUIRED TOOLS |
|------------------------------|
| FLAT SCREWDRIVER |
| USPS PROPRIETARY MCGARD TOOL |
| 3/8" SOCKET WRENCH |
| |
| |

| PART # | DESCRIPTION |
|--------|---------------------------|
| 84993 | 10-32 x .312 McGARD SCREW |
| 84994 | 10-32 X .375 1-WAY SCREW |
| 84995 | 8-32 X .250 1-WAY SCREW |
| 86091 | 10-32 LOCK NUT |
| 91255 | COVER - LATCHING ASSEMBLY |
| 91259 | COVER - ARROW LOCK |
| | ARROW LOCK |
| | |

PARCEL ARROW LOCK INSTALLATION

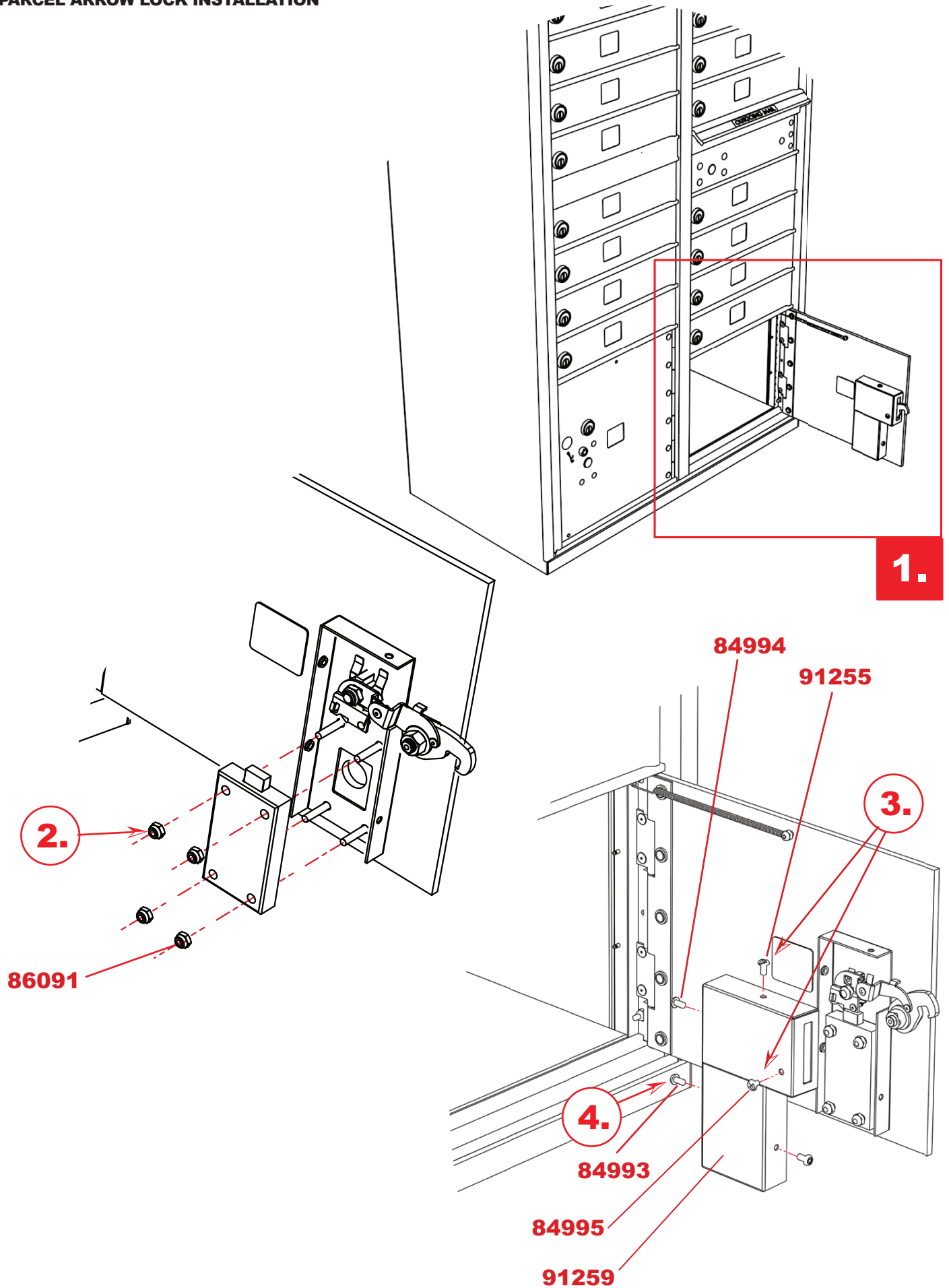

PEDESTAL TO CBU INSTALLATION

HIGH SECURITY METAL CBU TYPES I, II, III AND IV

1565 "REV 4" SERIES

PEDESTAL TO BOX

1. OPEN MASTER LOADING DOORS
2. REMOVE LEFT AND RIGHT SIDE 91079 FLOATING SHELVES, EXPOSING MOUNTING HOLES
3. PLACE UNIT ON PEDESTAL
4. FROM UNDERNEATH UNIT, INSERT FOUR (4) 86101 3/8-16 X 1.25 CARRIAGE BOLTS UPWARD
5. FROM ABOVE BOTTOM SHELVES, ADD FOUR (4) 86097 3/8" X .688 OD LOCK WASHER AND TIGHTEN FOUR (4) 86089B 3/8-16 HEX NUTS
6. REPLACE LEFT AND RIGHT SIDE 91079 FLOATING SHELVES

PEDESTAL TO CONCRETE PAD

1. POSITION RUBBER PAD AND PEDESTAL ON 4 ANCHOR BOLTS
 2. LOCATE AND TIGHTEN 4 1/2-13 ANCHOR NUTS, 2 OF THE 4 BEING McGARD SECURITY NUTS (92012) MOUNTED DIAGONALLY OPPOSED USING McGARD HEX NUT DRIVER (MES# 110005)
- TORQUE TO 50 FT. LBS.

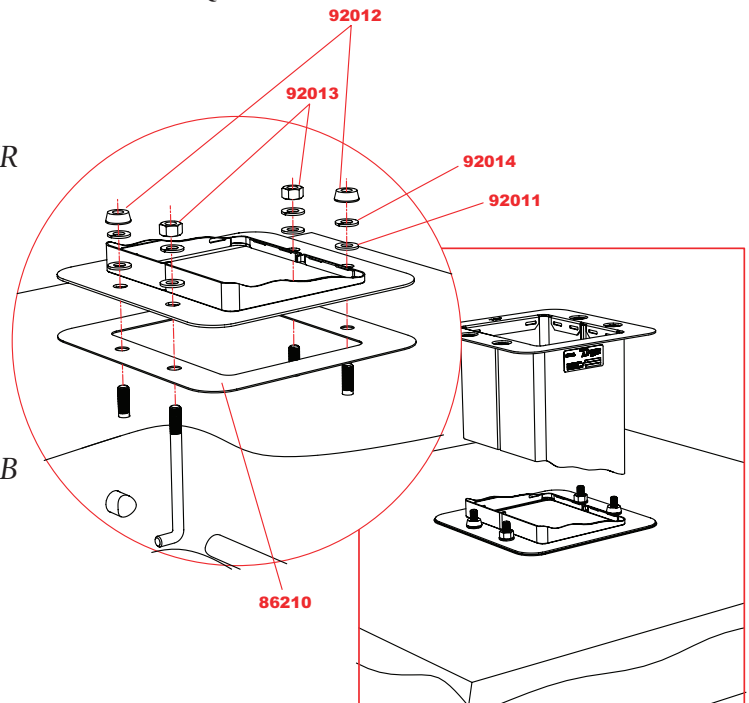

| REQUIRED TOOLS |
|-------------------------------------|
| 9/16" SOCKET WRENCH |
| TORX HEAD SCREWDRIVER/BIT |
| 3/4" SOCKET WRENCH |
| USPS PROPRIETARY McGARD DRIVER TOOL |
| |

| PART # | DESCRIPTION |
|--------|---|
| 86089B | 3/8-16 HEX NUT |
| 86097 | 3/8" X .688 OD LOCK WASHER |
| 86101 | 3/8-16 X 1.25 CARRIAGE BOLT |
| 86210 | PEDESTAL WASHER |
| 91079 | FLOATING SHELF |
| 91505 | PEDESTAL FOR TYPE III, IV |
| 91510 | PEDESTAL FOR TYPE I, II |
| 92011 | WASHER 1/2" SS |
| 92012 | NUT LOCK 1/2-13 McGARD CASE HARDENED PLATED STEEL |
| 92013 | NUT LOCK 1/2-13 SS |
| 92014 | WASHER LOCK 1/2" SS |

PEDESTAL TO CBU INSTALLATION

