

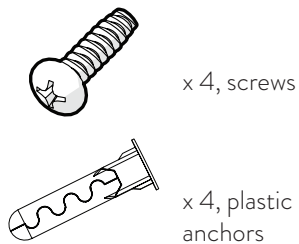

IMPORTANT! This mailbox is intended to be mounted under an eave or another protected area.

Hardware (included)



Tools (not included)

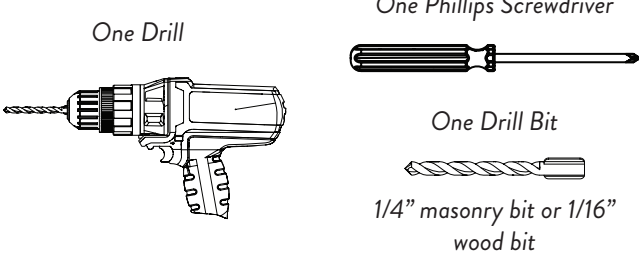

- Using the guide on the back of these instructions, mark the wall at the center of each crosshair. Use a level to ensure a straight installation (optional).

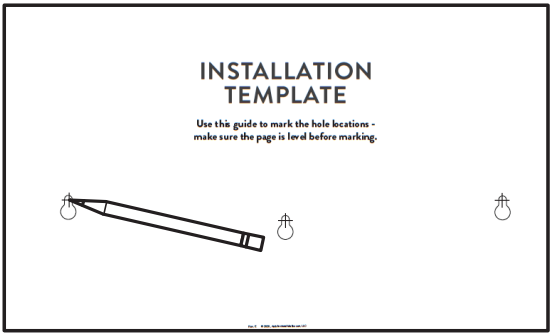

- Drill into the wall at each marked location. Use a 1/4" drill bit for brick or other masonry wall. Use a 1/16" drill bit for wood wall.

1/4" masonry bit
- or -
1/16" wood bit

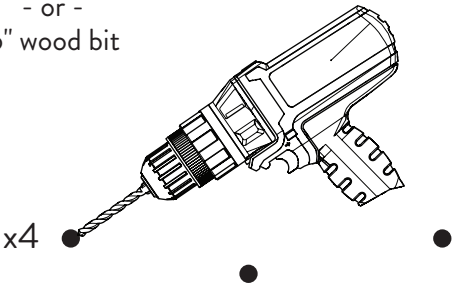

- Skip this step if installing into wood.** Insert the included plastic anchors into the drilled holes. Gently tap them in if necessary.

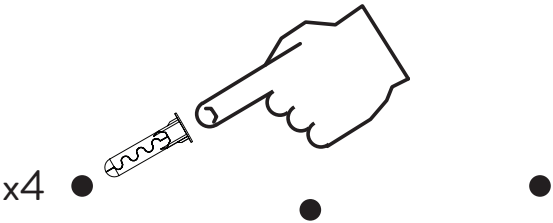

- Insert the screws into the drilled holes and secure with a screwdriver. Hang the mailbox onto the secured screws using the bottom eyelet holes on the back of the mailbox. With the mailbox hanging from the bottom screws, mark the wall in the center of the top two mounting holes.

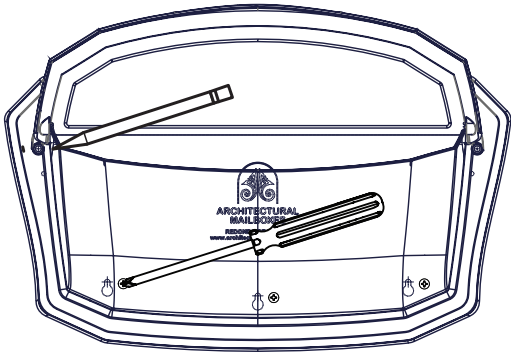

- Remove the mailbox from the wall and drill the remaining holes. Insert plastic anchors, if needed.

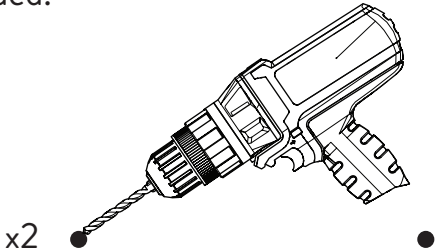

- Replace the mailbox, and secure using the two remaining screws.



INSTALLATION TEMPLATE

**Use this guide to mark the hole locations -
make sure the page is level before marking.**

