



# Wall Mount Mailbox | Model 2550 MOUNTING INSTRUCTIONS



**IMPORTANT! This mailbox is intended to be mounted under an eave or another protected area.**

## Hardware (included)

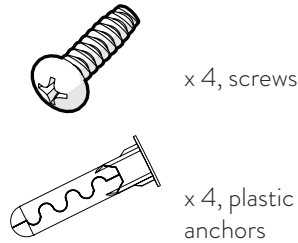

## Tools (not included)

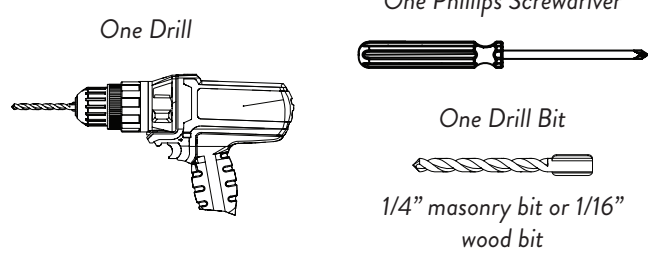

- 1 Using the guide on the back of these instructions, mark the wall at the center of each crosshair. Use a level to ensure a straight installation (optional).

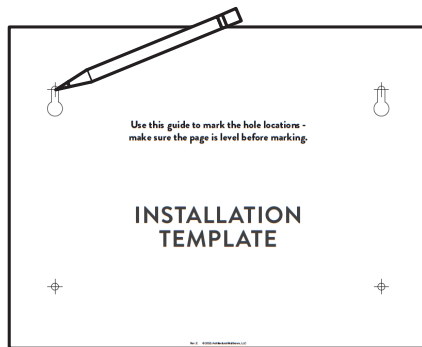

- 2 Drill into the wall at each marked location. Use a 1/4" drill bit for brick or other masonry wall. Use a 1/16" drill bit for wood wall.

1/4" masonry bit  
- or -  
1/16" wood bit

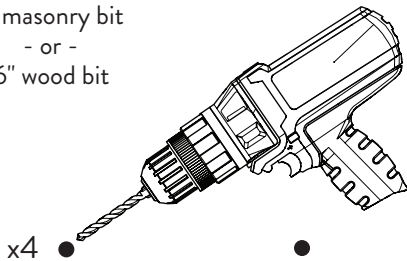

- 3 **Skip this step if installing into wood.**

Insert the included plastic anchors into the drilled holes. Gently tap them in if necessary.

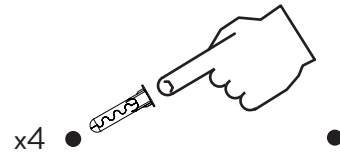

- 4 Insert the screws into the top two drilled holes and secure with a screwdriver. Hang the mailbox onto the secured screws using the top eyelet holes on the back of the mailbox.

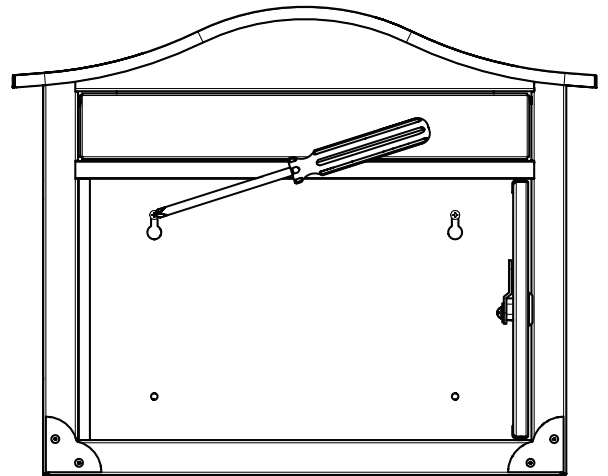

- 5 While the mailbox is hanging on the top screws, insert the remaining two screws into the bottom holes and secure with a screwdriver.

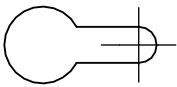

**Use this guide to mark the hole locations -  
make sure the page is level before marking.**

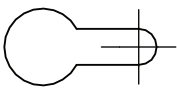

# INSTALLATION TEMPLATE

